



## 54 Barrie Road TULLAMARINE VIC

14 

Exceptional Commercial Investment.

Office/Warehouse premises purposefully located near the Melbourne International Airport and all major arterials.

Huge frontage of 34 m2 approximately; allows for plenty of car parking spaces plus hardstand and accommodates two motorised R.S.D's.

### Lease Summary:

- 3 years and 2 month lease; commenced 1st of July 2016.
- Remaining Options; 2 further terms of 3 years.
- Current Rent \$60,000.00 (plus GST if applicable) per annum (gross).
- Rent Reviews; CPI and Market review.

Total land area: 1,250.00 m2 approximately

Total building area: 810 m2 approximately

Zoned: Industrial 1 Zone (IN1Z)

Contact Jason Sassine 0419 332 536

[For full version visit the website](https://www.jasonrealestate.com.au)

**Type** : Industrial  
**Building Size** : 1251 sqm  
**Land Size** : 1251 sqm  
**View** : <https://www.jasonrealestate.com.au/sale/vic/north/tullamarine/commercial/industrial/7331024>



**Jason Sassine**  
03 9304 1444

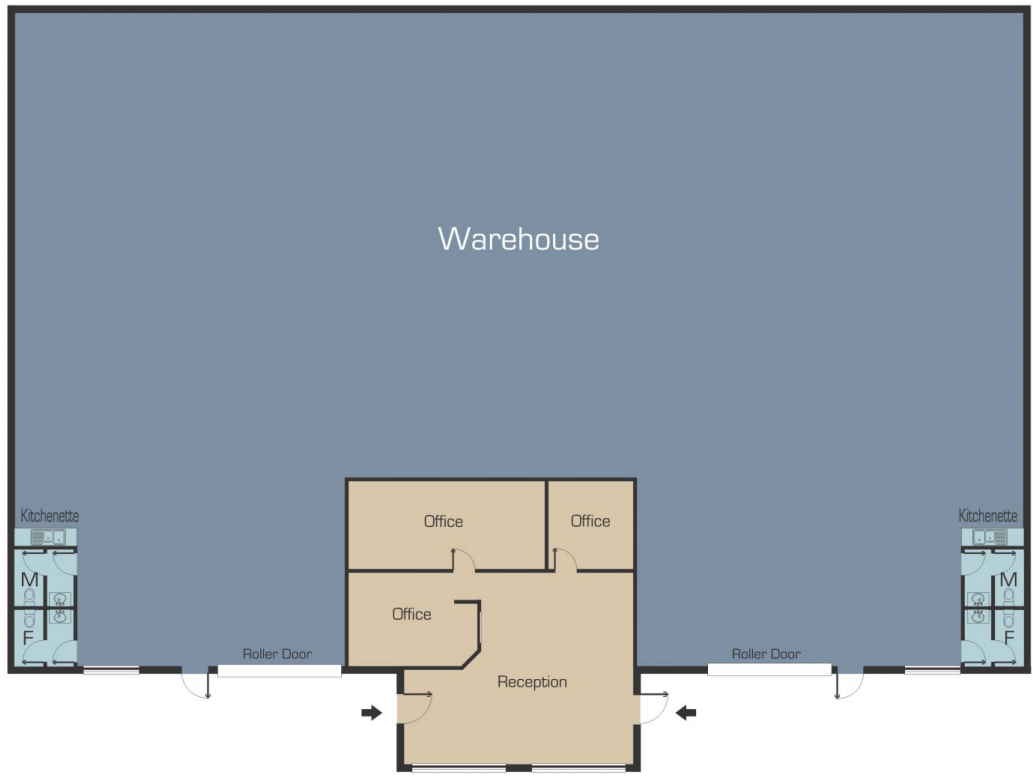

Disclaimer: Please note floor plans are indicative only not drawn to exact scale. All dimensions are approximate. Potential buyers should view the property in person.

54 Barrie Road Tullamarine