



465 Lygon Street BRUNSWICK EAST VIC

A rare opportunity to secure this retail premise in a prominent highly visible position. Offered for the first time in over 35 years, this property presents an investment opportunity for the astute buyer.

KEY FEATURES INCLUDE:

- * Total land area: 190 m2 approx
- * Total building area: 130 m2 approx
- * Large kitchen/preparation area's
- * Rear laneway access
- * Commercial 1 zone

LEASE DETAILS:

- * Rental: \$28,817 per annum plus GST and outgoings

[For full version visit the website](https://www.jasonrealestate.com.au/sale/vic/north/brunswick-east/commercial/retail/7331063)

Type	: Retail
Building Size	: 130 sqm
Land Size	: 190 sqm
View	: https://www.jasonrealestate.com.au/sale/vic/north/brunswick-east/commercial/retail/7331063

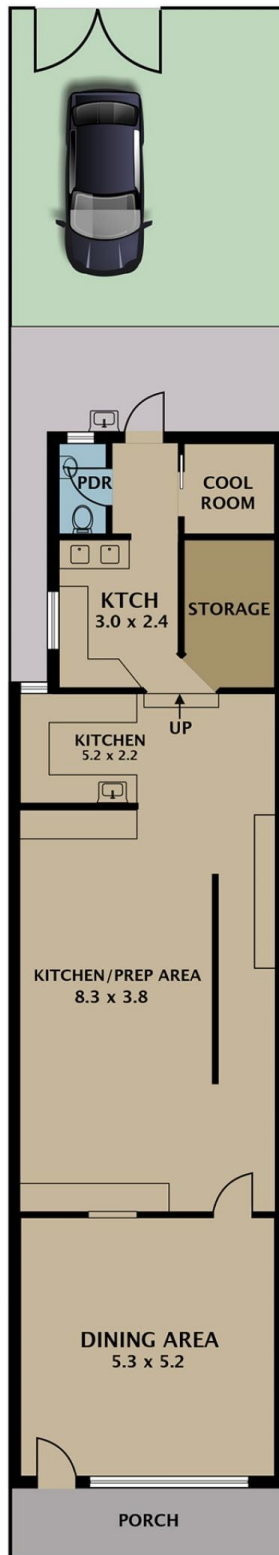

Disclaimer. Please note plans are indicative only and not drawn to exact scale. All dimensions are approximate. Potential buyers view the property in person.

465 Lygon St Brunswick East