



Leo Kikyris  
0408 365 860

Commercial/Industrial  
Division Manager



List your investment property with me today



## 29-31 Brooklyn Court Campbellfield VIC

17 🚗

Leo Kikyris & Steve Kikyris of Jason Commercial are pleased to offer for sale to the public market: 29-31 Brooklyn Court, Campbellfield.

This facility presents a HUGE opportunity to enter the lucrative Campbellfield industrial property market.

This heavy duty building has got it all including high capacity 3-phase power, two separate roller door entry points, excellent internal height clearance, ample offices/staff amenities, good amount of hardstand yard storage areas. The property also includes significant natural gas supply, which is a valuable asset to any business operation.

Property provides easy access to all major arterial roads such as Hume Hwy, Sydney Road, M80 Ring Road,

**Price** : \$ 2,600,000  
**Building Size** : 1421 sqm  
**Land Size** : 2354 sqm  
**View** : <https://www.jasonrealestate.com.au/sale/vic/north/campbellfield/commercial/industrial/7812850>



**Leo Kikyris**  
03 9304 1444



**Steve Kikyris**  
03 9304 1444

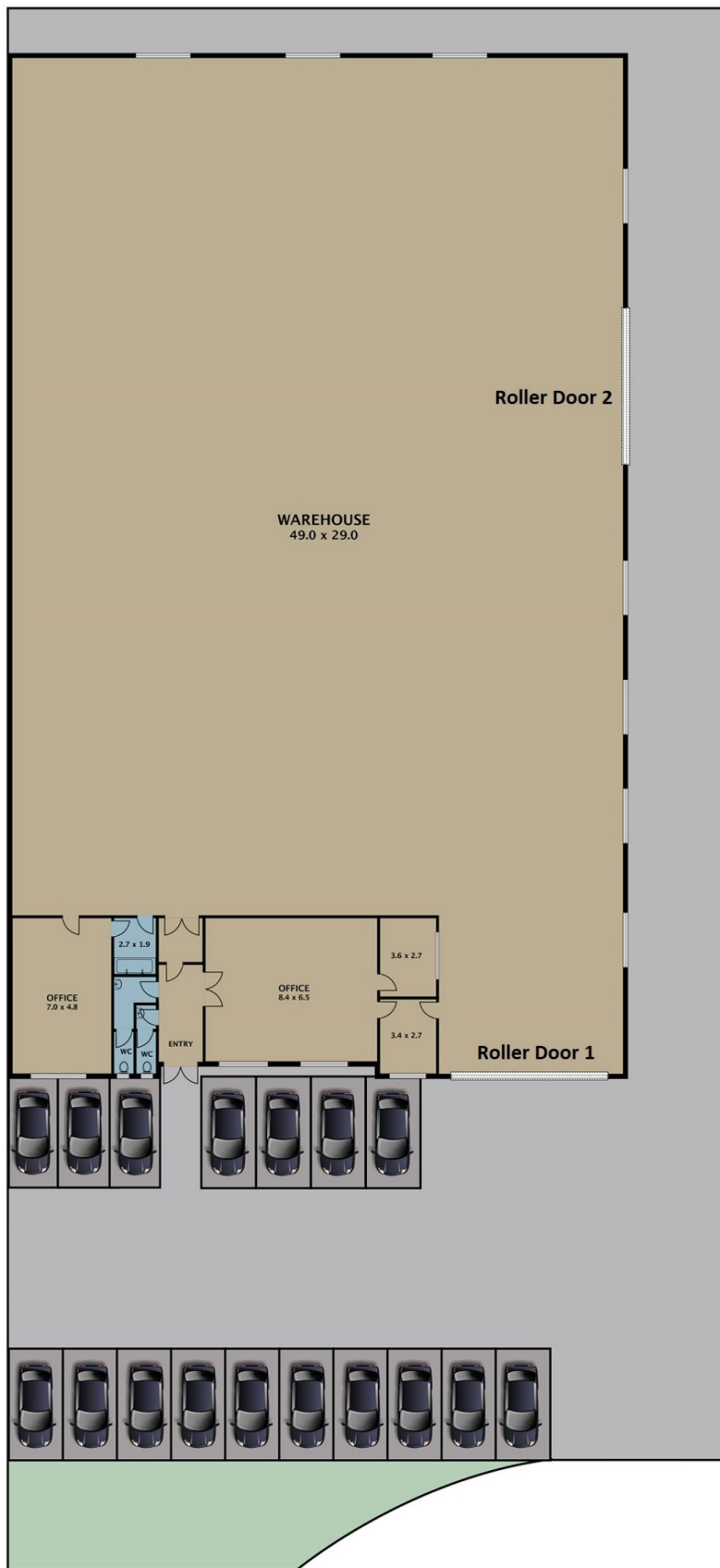

Disclaimer. Please note plans are indicative only and not drawn to exact scale. All dimensions are approximate. Potential buyers view the property in person.

# 29-31 Brooklyn Court Campbellfield