



8B/1-13 The Gateway Broadmeadows VIC

2 🚗

Leo Kikyris & Steve Kikyris of Jason Commercial are pleased to offer for lease to the public market: 8B/1-13 The Gateway, Broadmeadows, VIC 3047.

Take your business to the next level with this affordable professional office suite. Looking to upgrade or downsize this is the site for you. Established business park location. Within close proximity to major arterial roads.

KEY FEATURES INCLUDE:

- * 9B Permit Available
- * Total building area: 59 m2 approx
- * Elevator Access
- * Separate male/female toilets cleaned daily
- * 2 Car parking spaces
- * Kitchenette amenities
- * NBN Connected

Price : Contact Agent
Building Size : 59 sqm
Land Size : 59 sqm
View : <https://www.jasonrealestate.com.au/lease/vic/north/broadmeadows/commercial/offices/7966284>



Steve Kikyris
03 9304 1444



Leo Kikyris
03 9304 1444

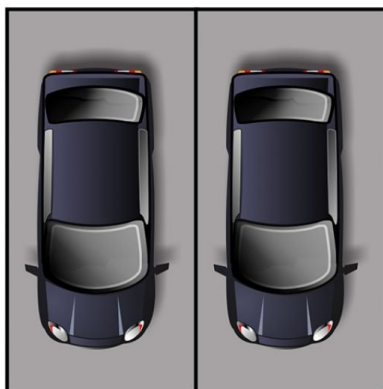

**2 X CAR SPACE
(NOT IN POSITION)**

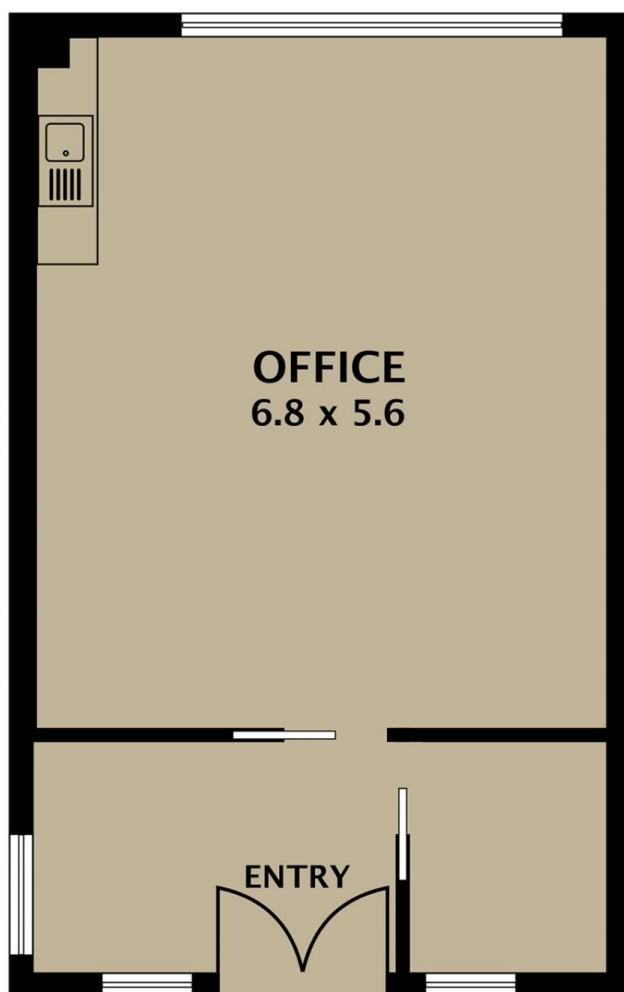

Disclaimer. Please note plans are indicative only and not drawn to exact scale. All dimensions are approximate. Potential buyers view the property in person.

8b/1-13 The Gate Way Broadmeadows