

## 6/41-43 Allied Drive Tullamarine VIC

2 🚗

Jason Sassine of Jason Commercial is pleased to offer for sale or lease to the public market: 6/41-43 Allied Drive, Tullamarine.

This outstanding facility provides an AFFORDABLE opportunity for any small to medium sized operator to secure an ample sized warehouse/office.

This property is located with easy access to all major arterial roads such as Sharps Road, Keilor Park Drive, Calder Freeway, Western Ring Road, City Link Roll Roads and close proximity to the Melbourne (MEL) and Essendon Fields Airport/s (MEB).

KEY FEATURES INCLUDE:

[For full version visit the website](#)

**Type** : Industrial  
**Building Size** : 200 sqm  
**Land Size** : 100 sqm  
**View** : <https://www.jasonrealestate.com.au/lease/vic/north/tullamarine/commercial/industrial/8078084>



**Jason Sassine**  
03 9304 1444

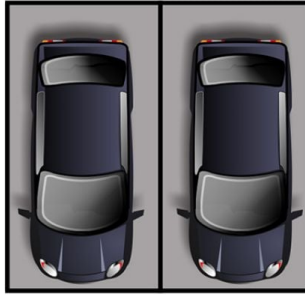

(NOT IN POSITION)

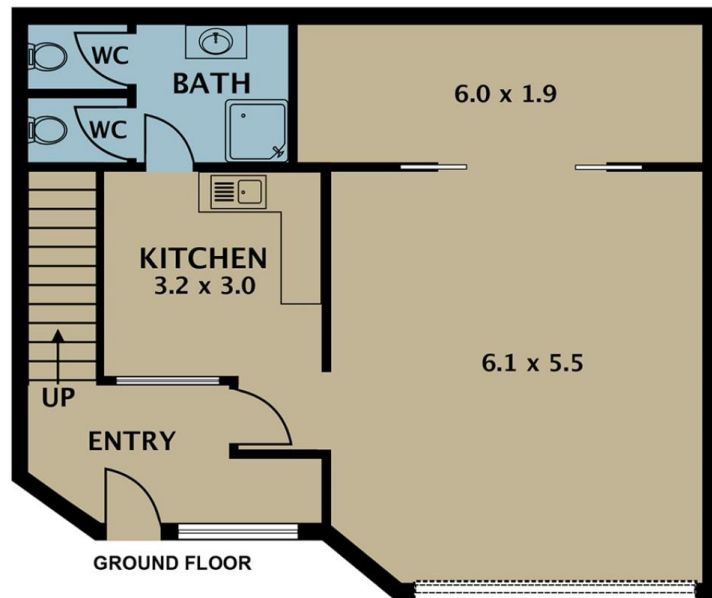
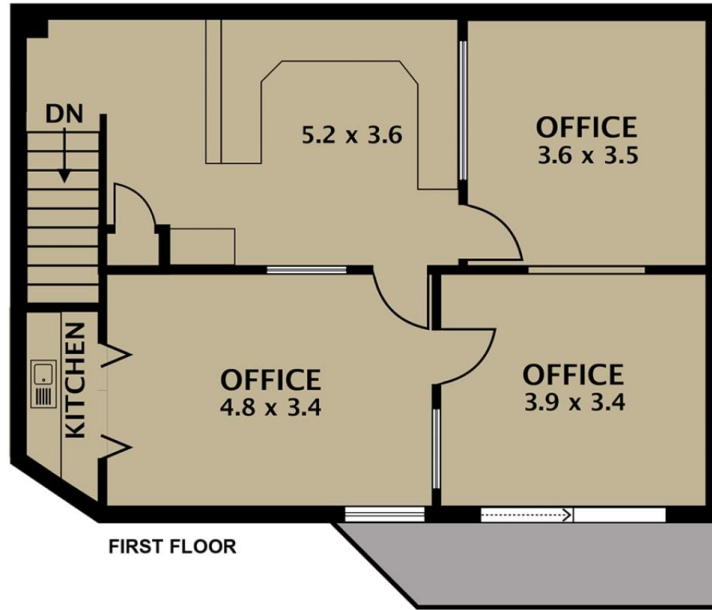

Disclaimer. Please note plans are indicative only and not drawn to exact scale. All dimensions are approximate. Potential buyers view the property in person.

6/41-43 Allied Drive Tullamarine