



14/72 Logistics Street Keilor Park VIC

2 🚗

Leo Kikyris & Steve Kikyris of Jason Commercial are pleased to offer for lease to the public market: 14/72 Logistics St, Keilor Park.

Nestled in the sought-after Translink Business Park, this modern warehouse/office offers seamless access to Keilor Park Drive and major arterials like Calder Fwy, Western Ring Rd, and Tullamarine Fwy-ideal for businesses requiring proximity to Melbourne Airport and the CBD.

KEY FEATURES:

- * Total building area: 165sqm (approx.)
- * 2x allocated car spaces
- * Secure gated compound
- * Commercial 2 Zone

[For full version visit the website](https://www.jasonrealestate.com.au/lease/vic/north/keilor-park/commercial/industrial/8166467)

Type : Industrial
Price : Contact Agent
Building Size : 165 sqm
Land Size : 90 sqm
View : <https://www.jasonrealestate.com.au/lease/vic/north/keilor-park/commercial/industrial/8166467>



Leo Kikyris
03 9391 1111



Steve Kikyris
03 9391 1111

14 / 72 LOGISTICS STREET, KEILOR PARK

TOTAL BUILDING AREA: 165m²



FIRST FLOOR

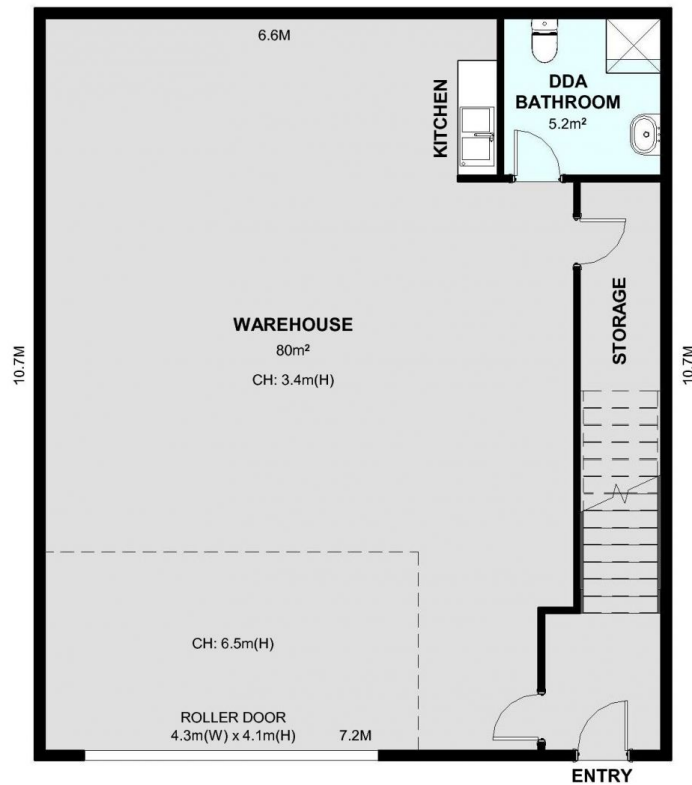

GROUND FLOOR

PLEASE NOTE FLOOR PLANS ARE SHOWN INDICATIVE ONLY AND ARE NOT DRAWN TO EXACT SCALE - BUYERS PLEASE INSPECT PROPERTY IN PERSON